

ADS-721

DOUBLE ENDED SHEAR BEAM LOAD CELL



DESCRIPTION :

ASB-721 is a high accuracy, low profile double ended shear beam load cell suitable for Tank, Hopper & Truck Weighing.

APPLICATIONS :

- Tank, Hopper & Silo Weighing
- Truck Weighing
- Tensile Testing

KEY FEATURES :

- Wide capacity range from 2.5 tonf to 100 tonf
- Alloy Tool Steel construction
- High Environment Protection

SPECIFICATIONS :

Rated capacity (Tonf.)	: 2.5, 3, 5, 10, 15, 20, 30, 40, 50, 75
Excitation Voltage	: 10VDC-Maximum 15 VDC
Rated Output	: 3.0 mV/V
Non – Linearity	: $< \pm 0.025$ % FSO (Full scale Output)
Hysteresis	: $< \pm 0.02$ % FSO
Non-Repeatability	: $< \pm 0.01$ % FSO
Creep error (30 minutes)	: $< \pm 0.03$ % FSO
Zero Load Output	: ± 1.0 % FSO
Input Resistance	: 770 ± 20 Ohms
Output Resistance	: 700 ± 7 Ohms
Insulation Resistance	: > 1000 Mega Ohms
Side Load Allowed	: 50 % of Rated Capacity
Safe Overload	: 150 % of Rated Capacity
Ultimate Overload	: 250 % of Rated Capacity
Temperature	: 0 to 60° C
Compensated Range	
Temperature Effect on Output	: < 0.0015 % FSO/° C
Temperature Effect on Zero	: < 0.002 % FSO/° C
Deflection	: < 0.5 mm at FSO
Tightening Torque	: 10 Kg-m.
Finish & Construction	: Electroless Nickel Plated Tool Steel.
Environment Protection	: IP 68 compatible



ADI CONTROLS

1B,1C POR INDUSTRIAL PARK
BEHIND SAHYOG HOTEL
POR 391243 DIST VADODARA (INDIA)

www.adicontrols.com

Email : sales@adicontrols.com

Customer Care : +91 9328579990

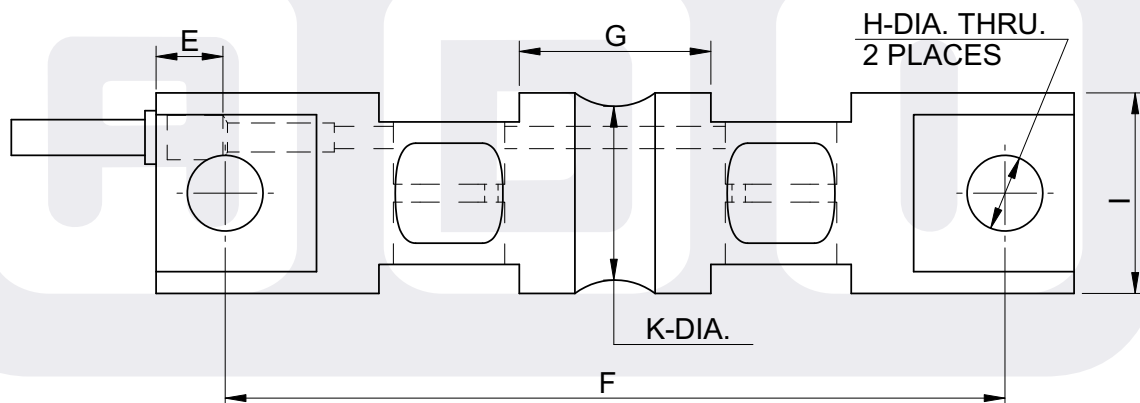
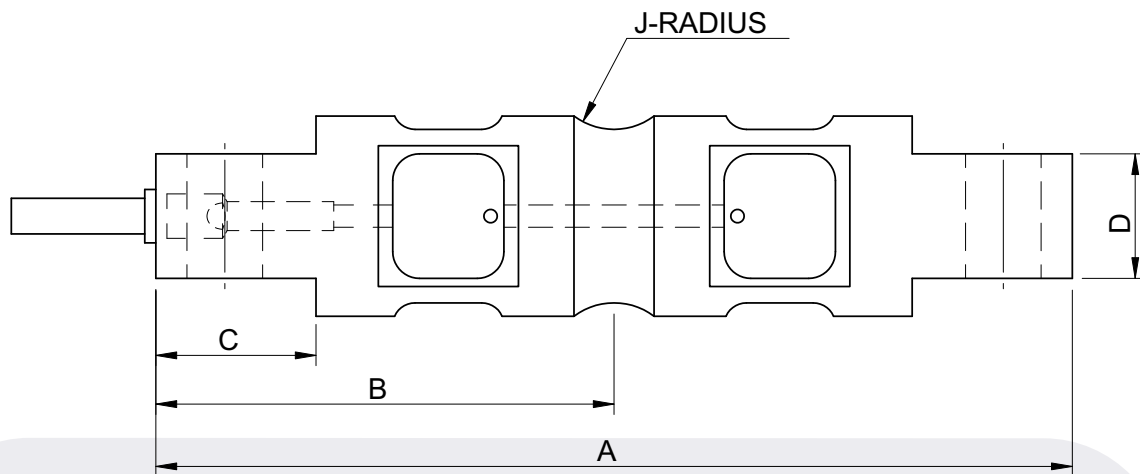

Electrical Termination

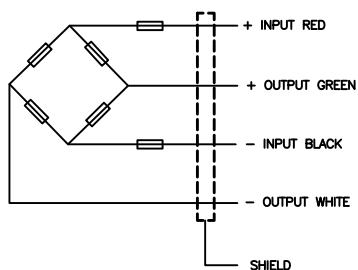

ARROW SHOWS LOAD DIRECTION FOR +VE OUTPUT

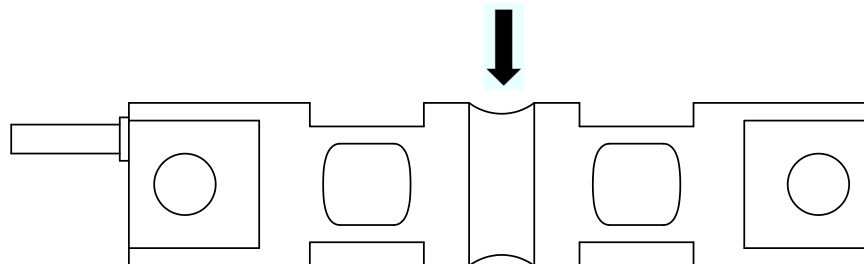

CAPACITY Tf	A	B	C	D	E	F	G	H	I	J	K	CABLE
2.5, 3, 5, 10	206	103	36	28	15.5	175	25	17	45	12.5	38	10 Mtrs.
15, 20, 30, 40	260	130	47	60	22	216	35	25	78	25	70	10 Mtrs.
50, 75	285	143	47	63.5	22	241	35	25	88	25	80	10 Mtrs.



ADI CONTROLS

1B,1C POR INDUSTRIAL PARK
BEHIND SAHYOG HOTEL
POR 391243 DIST VADODARA (INDIA)

www.adicontrols.com

Email : sales@adicontrols.com

Customer Care : +91 9328579990